

!! READ FIRST !!

SOLA is shipped with the handle in the locked position. **DO NOT** turn the handle to the unlocked position until Lock Orientation and Cam & Cam Stop Position have been determined.

Lock Orientation - Views

SOLA can be installed vertically or horizontally for left or right handed configuration.

Vertical

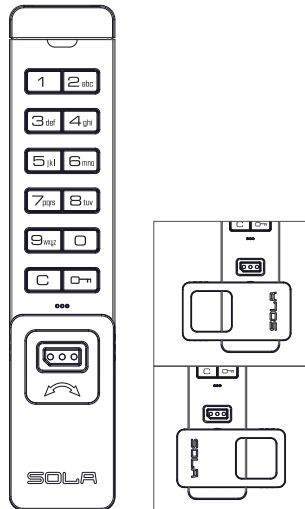

Locked Position Unlocked Position

Horizontal Left Handed

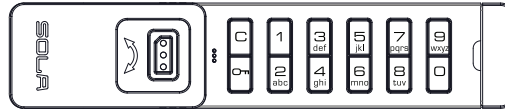

Locked Position

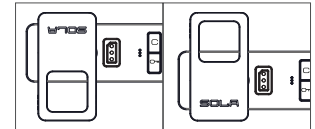

Unlocked Position

Horizontal Right Handed

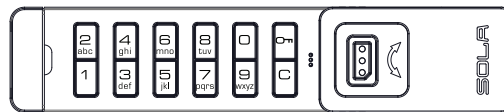

Locked Position

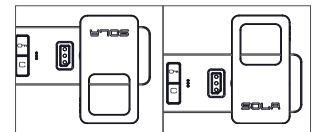

Unlocked Position

Cam & Cam Stop Position

Note: The position of the cam and cam stop varies depending on whether it is vertically or horizontally installed for a left or right handed configuration.



**Vertical
Back-View**

Cam throw: right

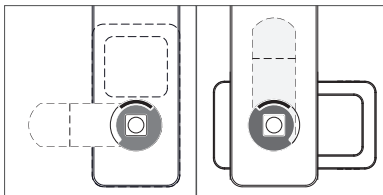

Locked Position Unlocked Position



Cam throw: left

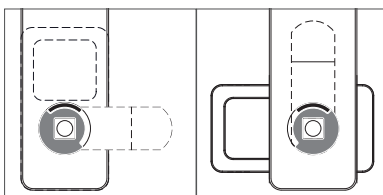

Locked Position Unlocked Position



**Horizontal Left Handed
Back-View**

Cam throw: top

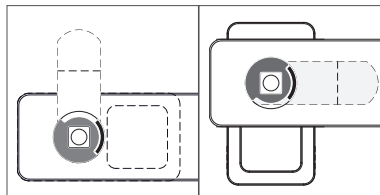

Locked Position Unlocked Position



Cam throw: bottom

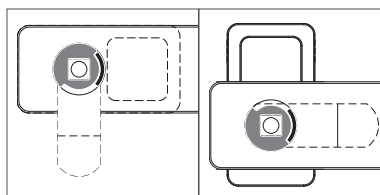

Locked Position Unlocked Position



**Horizontal Right Handed
Back-View**

Cam throw: top

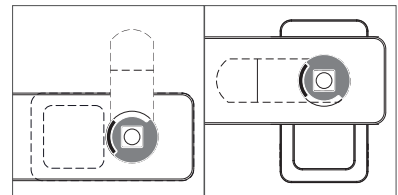

Locked Position Unlocked Position



Cam throw: bottom

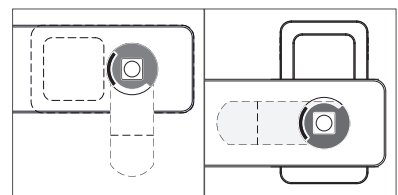

Locked Position Unlocked Position

IMPORTANT: Do not operate and turn the handle to the unlocked position without first installing the lock or determining whether the lock is for a left or right handed configuration.

Hardware & Mounting

Door thickness: 0.1–5mm (.01”-.197”)
Use upper nut hardware

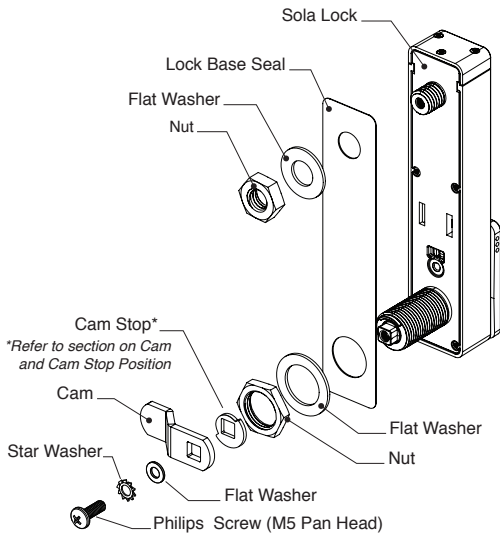

Door thickness: 6-10mm (.236”-.394”)
Use upper screw hardware

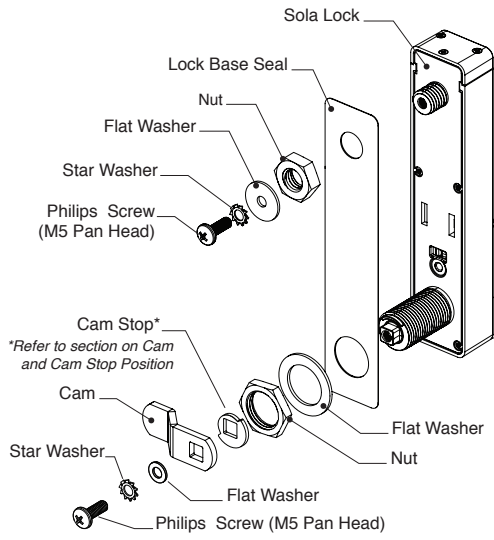

Door thickness: 11-22mm (.433”-.866”)
Use upper screw hardware

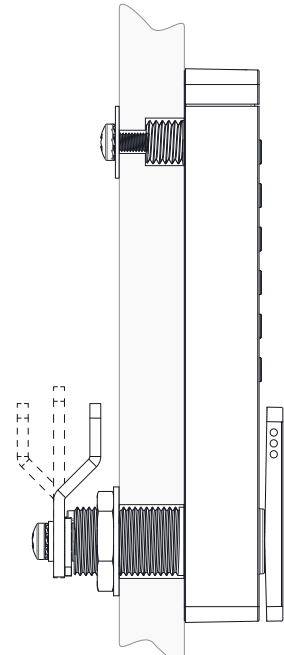
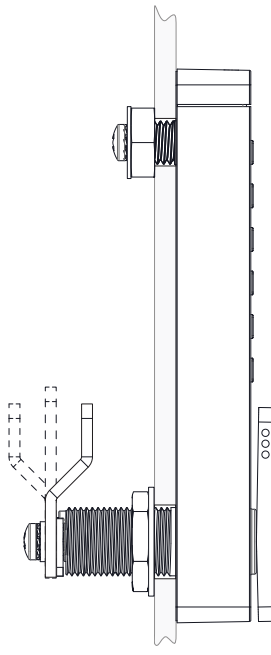
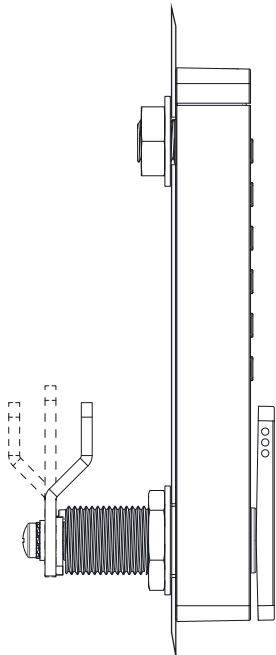
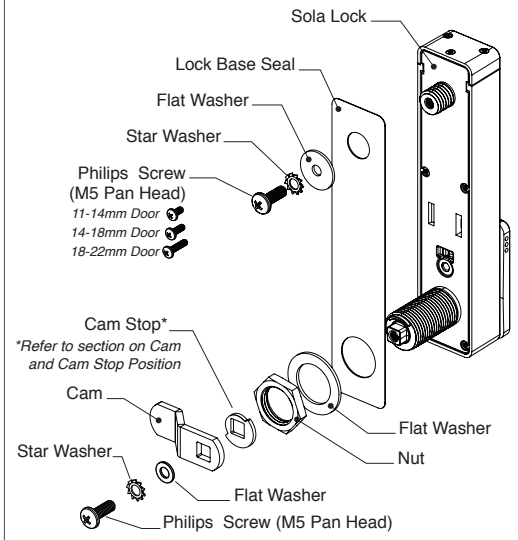

Keys



User Key



Manager Key*



Programming Key**

Operates the lock	●	●	●
Overrides user access		●	●
Allows access for management inspection		●	●
Provides external power		●	●
Assigns user credential		●	
Sets lock functionality			●

*Up to 25 Manager Keys may be registered to a lock. **1 Programming Key allowed per lock group.

Key Insertion

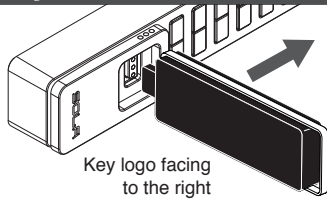

Key logo facing to the right

Horizontal Left-Hand

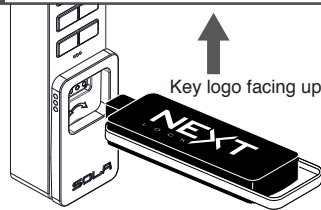

Key logo facing up

Vertical

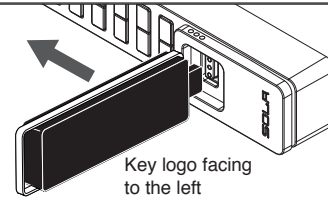

Key logo facing to the left

Horizontal Right-Hand

For Lost or Stolen Keys

For a lost or stolen Programming Key:

A replacement Programming Key must be purchased and registered to the lock(s) to prevent the lost/stolen Programming Key from accessing/programming a lock.

For a lost or stolen Manager Key(s):

All registered Manager Keys must be erased and only the remaining Manager Keys must be registered to the lock(s) to prevent the lost/stolen Manager Key from accessing a lock. Purchase additional Manager Key(s) from an authorized dealer.

- Collect all remaining Manager Key(s).
- Press **C 0m 5 5 0m**. The LED will turn on.
- Touch the Programming Key to the key slot until a two-tone beep is heard.
- Touch the Programming Key to the key slot again until three sets of two-tone beeps are heard and the LED turns off. All previously registered Manager Key(s) have been erased from the lock.
- Follow [Register/Add Manager Key\(s\)](#) instructions to register the remaining Manager Key(s).

Battery Replacement

1) Remove battery cover.

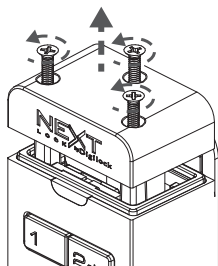

2) Pull batteries out.

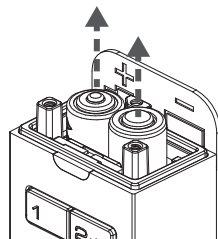

3) Replace with 2 AAA batteries.

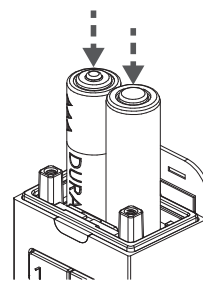

4) Place the battery cover and secure.

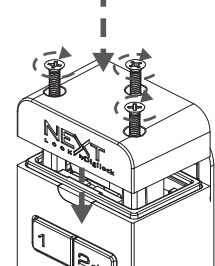

Programming Instructions

INSTALL THE LOCK OR DETERMINE CONFIGURATION PRIOR TO PROGRAMMING AND OPERATING.

Default Settings

Functionality = Shared Use

Initial Setup

New locks operate with **[C] [0m]**. Locks must be setup to allow full operation.

- Touch the Programming Key to the key slot until a two-tone beep is heard and the LED turns on.
- Touch each Manager Key to the key slot. A two-tone beep will be heard for each Manager Key that is successfully registered.
- Touch the Programming Key to the key slot until a two-tone beep is heard and the LED turns off.
- Repeat above steps for each lock or follow [Express Register](#) instructions to setup all locks.

Express Register

Manager Key(s) can be quickly registered to multiple locks. The Programming Key copies the registered Manager Key(s) from one lock to multiple locks.

- Go to the lock registered with the Manager Key(s).
- Press **[C] [0m] [6] [6] [0m]**. The LED will turn on.
- Touch the Programming Key to the key slot until a two-tone beep is heard and the LED turns off.
- At each lock to be registered, touch the Programming Key to the key slot until a two-tone beep is heard and the LED flashes once to indicate successful registration.
- End express registration.* Go to any registered lock and press **[C] [0m]** then touch the Programming Key to the key slot to operate the lock.

* The Programming Key will continue to function in express registration mode until it is used to operate a lock.

Register/Add Manager Key(s)

Manager Key(s) can be registered to a lock after Initial Setup has been completed.

- Go to the lock requiring Manager Key(s).
- Press **[C] [0m] [5] [5] [0m]**. The LED will turn on.
- Touch the Programming Key to the key slot until a two-tone beep is heard.
- Touch each Manager Key to the key slot. A two-tone beep will be heard for each Manager Key that is successfully registered.
- Touch the Programming Key to the key slot until a two-tone beep is heard and the LED turns off.
- Repeat above steps for each lock or follow [Express Register](#) instructions to register the same Manager Key(s) to multiple locks.

Set Lock Functionality

Each lock can be set for either shared or assigned use functionality. In shared use functionality, the user enters a self-selected 4-digit code or touches any User Key to lock and later unlock. Once unlocked, the lock is available to be used by a different user. In assigned use functionality, the lock is programmed with an assigned user credential (4-digit code or User Key). The user enters the assigned user credential to unlock and turns the handle to relock. Press **[C]** to check functionality. If in shared use, LED is **RED**. If in assigned use, LED is **GREEN**.

Set lock for shared use functionality (default):

- Press **[C] [0m] [5] [6] [0m]**. The LED will turn on.
- Touch the Programming Key to the key slot until a two-tone beep is heard and the **RED** LED flashes once.
- Make sure the lock is unlocked and available for use. Use a registered Manager Key or the Programming Key to unlock.

Set lock for assigned use functionality:

- Press **[C] [0m] [6] [5] [0m]**. The LED will turn on.
- Touch the Programming Key to the key slot until a two-tone beep is heard and the **GREEN** LED flashes once.
- Assign a user credential (code or key) to the lock. Follow [Assign a User Credential](#) instructions.
- Make sure lock is in the locked position. Use a registered Manager Key or the Programming Key to lock.

Assign a User Credential (for assigned use functionality only)

Make sure that the lock is set for assigned use functionality. Once a user credential is assigned, the previously assigned user credential will no longer operate the lock.

Assign a User Code (default user code = 1234):

- Press **[C]** **[07]** then touch a registered Manager Key to the key slot until the green LED turns on.
- Press **[C]** [new assigned 4-digit User Code] **[07]**. A two-tone beep will be heard.
- Press **[C]** [the same new assigned 4-digit User Code] **[07]**. Two sets of two-tone beeps will be heard and the LED will turn off.

Assign a User Key:

- Press **[C]** **[07]** then touch a registered Manager Key to the key slot until the green LED turns on.
- Touch the User Key to be assigned to the key slot until a two-tone beep is heard and the LED turns off.

Operating Instructions

Shared Use Functionality

Operate with a self-selected User Code:

Make sure the lock is unlocked and available for use. Use the Programming or Manager key to unlock.

- To lock: Close the door, Press **[C]** [any 4-digit User Code] **[07]**, and then turn the handle to the locked position.
- To unlock: Press **[C]** [the same 4-digit User Code] **[07]**, turn the handle to the unlocked position, and then open the door.*

Operate with any User Key:

- To lock: Close the door, touch any User Key to the key slot, and then turn the handle to the locked position.
- To unlock: Touch any User Key to the key slot, turn the handle to the unlocked position, and then open the door.

Operate with a registered Manager Key:

- To unlock: Touch any registered Manager Key to the key slot, turn the handle to the unlocked position, and then open the door.
- To relock: Close the door, touch any registered Manager Key to the key slot, and then turn the handle to the locked position.**

Operate with the Programming Key:

- To unlock: Press **[C]** **[07]**, touch the Programming Key to the key slot, turn the handle to the unlocked position, and then open the door.
- To relock: Close the door, press **[C]** **[07]**, touch the Programming Key to the key slot, and then turn the handle to the locked position.**

Assigned Use Functionality

Operate with an assigned User Code:

- To unlock: Press **[C]** [assigned 4-digit User Code] **[07]**, turn the handle to the unlocked position, and then open the door.*
- To relock: Close the door and then turn the handle to the locked position.

Operate with an assigned User Key:

- To unlock: Touch the assigned User Key to the key slot, turn the handle to the unlocked position, and then open the door.
- To relock: Close the door and then turn the handle to the locked position.

Operate with a registered Manager Key:

- To unlock: Touch a registered Manager Key to the key slot, turn the handle to the unlocked position, and then open the door.
- To relock: Close the door and then turn the handle to the locked position.

Operate with the Programming Key:

- To unlock: Press **[C]** **[07]**, touch the Programming Key to the key slot, turn the handle to the unlocked position, and then open the door.
- To relock: Close the door and then turn the handle to the locked position.

* After three consecutive incorrect entries to unlock, the lock will go into "Sleep Mode" for one minute and for an additional minute for each subsequent incorrect entry. The keypad is disabled while in "Sleep Mode". For immediate access, use the Manager or Programming Key.

**If a Manager or Programming Key is used to unlock and relock, the previous User Code will continue to operate the lock.